

## Inspired Students Lead the Way >>

During consultation exercises led by EDP's landscape architects, pupils at St. Bartholomew's School in Newbury were keen to get involved in the construction of the new school grounds and ecological enhancements.

Although the scheme itself hasn't commenced on the ground as yet, the students are pushing ahead with their own involvements.

Year 10 students at the school have been busy constructing bird and bat boxes, following instructions provided by the EDP Landscape and Ecology Team. The boxes will be put up on mature trees at the site, to provide nests and shelter around the grounds, in line with the ecological mitigation and enhancement scheme developed by EDP.

Year 8 students have established an experiment, to test green roof Sedum varieties and determine which will be best suited to the new school buildings.

EDP have introduced the school to Dr Alun Tarr of Blackdown Horticultural - specialists in roof planting systems. Alun is now working with the students to assess the value of their proposed Green Roof. Students have learned that a green roof provides insulation, keeping the building warm in winter and cool in summer. It also helps prevent flooding, as the plants absorb rainwater and hence minimise runoff from the roof.



## BREEAM – Credit where Credits are Due >>

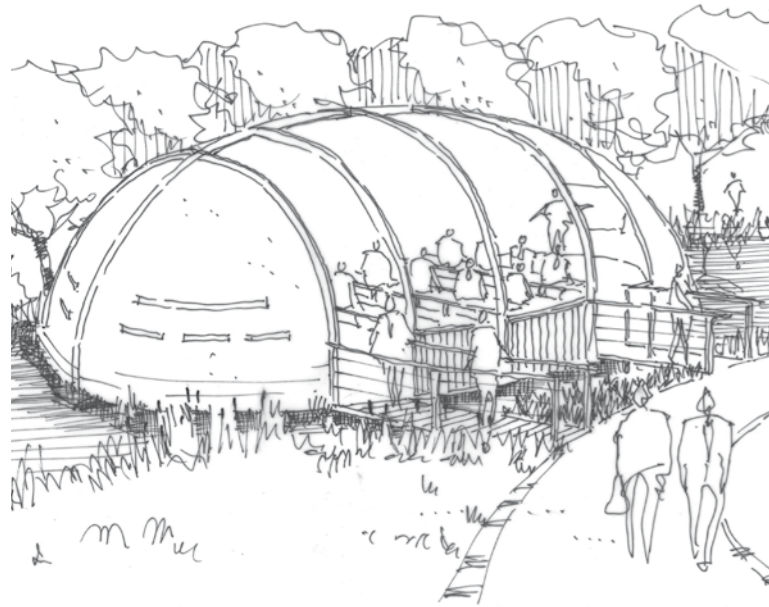

BREEAM environmental assessment methods are designed to help construction professionals understand, and mitigate, the impact of the developments they design and build. EDP frequently inputs to BREEAM assessments on a wide range of developments, including a warehouse scheme in Croydon, which won the BREEAM: Industrial Award in 2008.

EDP's role in the BREEAM process is to achieve as many credits as possible within the Land Use and Ecology section. This is achieved by early involvement, to assess and protect existing ecological assets and the development of a bio-diverse landscape scheme, which protects and enhances the wildlife value of the site.

Not only does this approach facilitate high scores within the BREEAM process (particularly as credits within the Land Use and Ecology section carry more weight than others), but it also promotes Sustainable Landscapes that offer added wildlife value and increased opportunities for outdoor education and play.

## who to contact...

Ecology  
**Rob Rowlands - Partner**

BSc (Hons), PhD, MIEEM, CEnv  
t 01285 640640 m 07920 027569  
e robertr@edp-uk.co.uk

Archaeology and Heritage  
**Andrew Crutchley - Associate**

BA(Hons), PG Dip (Oxon), MIFA  
t 01285 640640 m 07795 511092  
e andrewc@edp-uk.co.uk

Landscape  
**Dai Lewis - Landscape Consultant**

BA (Hons) Dip LA, CMLI  
t 01285 640640 m 07917 061056  
e dail@edp-uk.co.uk



## Introduction

We passionately believe that EDP is the best-placed consultancy, to provide 'soft' environmental planning and design services, for education projects in the UK. We deliver a truly integrated approach to the investigation and resolution of landscape, ecology and cultural heritage issues, through a 'small team' culture, where each project receives Partner level involvement within a flexible fee structure.

## EDP SERVICES >>

Our core disciplines are:

- Ecology and Protected Species
- Landscape Planning and Design
- Arboriculture
- Archaeology and Built Heritage
- Rights of Way
- Environmental Impact Assessment

## EDP Experience >>

Since our foundation in 2005, EDP has completed numerous projects involving schools and colleges. We offer a wide range of topic-based consultancy services, but are frequently commissioned to complete holistic landscape, arboriculture and ecology services, to create environmentally driven landscape masterplans, reflecting our approach as "environmental planners". In this respect, we stay up to date with new guidance and emerging policy, to remain on the front foot in this sector.



Our project experience includes:

### St Bartholomew's School

We provided ecology, arboriculture, landscape and consultation services on this scheme for a replacement secondary school in Newbury. We created an eco-centric landscape scheme, with a wholly native plant palette and a 4000m<sup>2</sup> Living Roof.

### Herefordshire College of Technology

We are currently providing ecological and landscape assessment services for the replacement Holme Lacey campus on the banks of the River Wye. This work is informing the masterplan process, and will support a planning application in 2009. We look forward to further involvements on Landscape Design in the near future.

### East Berkshire College

East Berkshire College are undertaking a multi-million pound project to redevelop and upgrade their Langley campus. EDP's involvement has included archaeological, landscape design and arboricultural inputs to inform the planning and design processes.

### Tilehurst Special School

EDP have undertaken a Zone of Visual Influence Assessment for the proposed Tilehurst Site. The assessment used GIS and Topographic Data to assess the theoretical Visual Envelope of the site. The results were then interrogated by EDP's Landscape Architects on site and a true Visual Envelope defined.

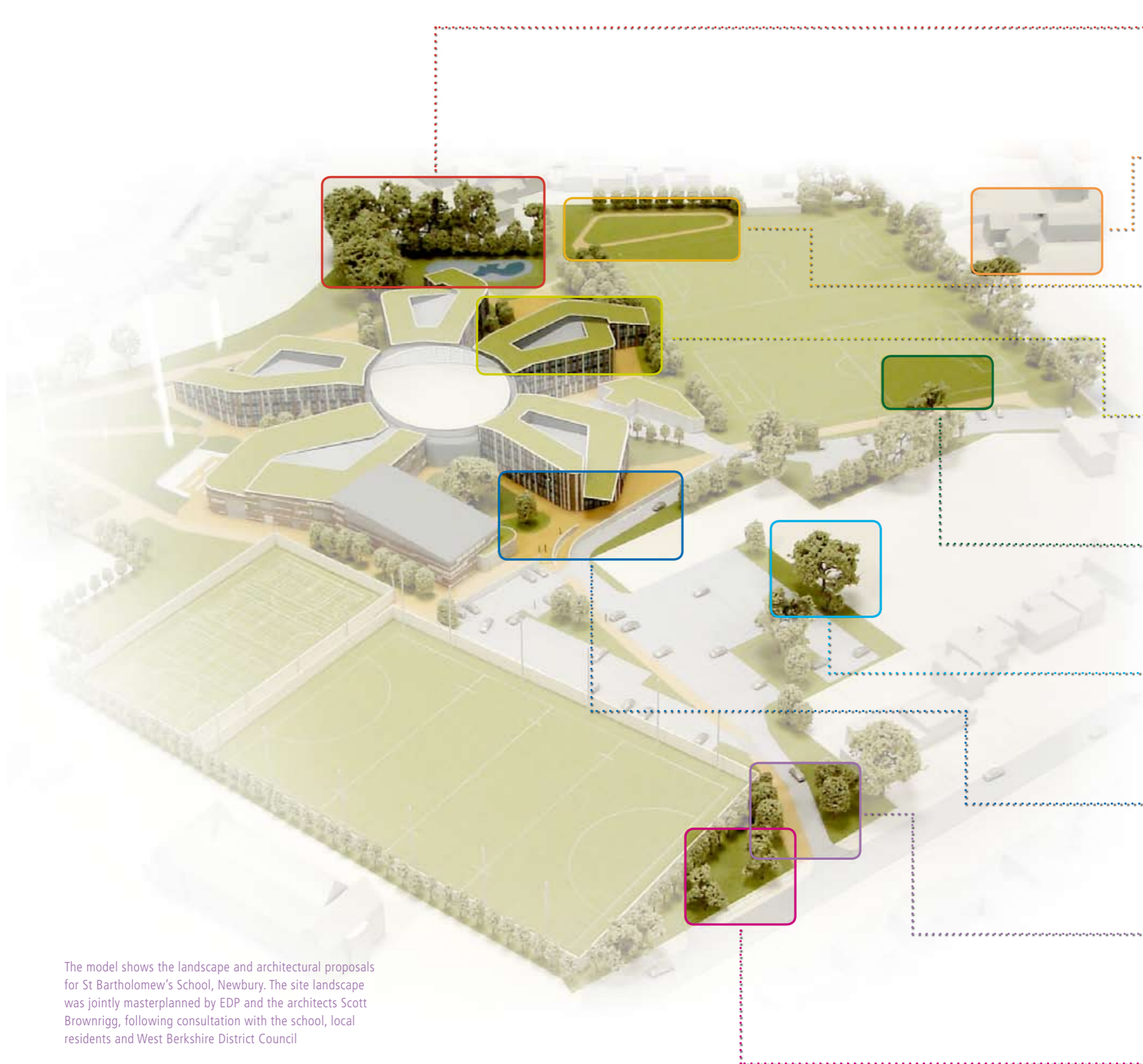

The model shows the landscape and architectural proposals for St Bartholomew's School, Newbury. The site landscape was jointly masterplanned by EDP and the architects Scott Brownrigg, following consultation with the school, local residents and West Berkshire District Council

Ecology drives our school landscape design process. This assists in achieving BREEAM credits but, more importantly, provides an exciting environment for both wildlife and students alike.

ecology & biodiversity

EDP's consultants can undertake consultation exercises and workshops with staff, students and the general public. These sessions inform the landscape design, creating an integrated solution to user needs.

consultation

Working with well known play and outdoor exercise equipment manufacturers, EDP's Landscape Architects can design bespoke play solutions to suit the needs of the school and its students.

play

Green Roofs offer excellent biodiversity and are a valuable part of any sustainable school landscape. We work with a range of providers and can ensure the most appropriate ecological planting is incorporated.

green roof design

In areas with archaeological potential, we provide surveys and reporting to support the planning process. In addition, our built heritage specialists complete assessments to inform the design and subsequent negotiations.

archaeology assessment

Existing trees need careful consideration during the design phases, and protection during construction. Our arborists can provide BS5837 surveys for planning and can supervise works during construction.

arboriculture

Using the School Premises Regs and BB98 as a starting point, our hard landscape designs offer students an exciting extension to the building - fun for recreation and stimulating for learning.

hard landscape design

Working with architects and engineers, EDP ensures that safe routes are provided around the site, meeting the needs of all potential users. DDA requirements are accommodated and a pleasant environment created.

access and circulation

Driven by sustainability, our soft landscape schemes focus on native planting and the creation of diverse ecological habitats. Opportunities abound for study, interaction and future flexibility.

soft landscape design